

P.P.H.U. POKORA

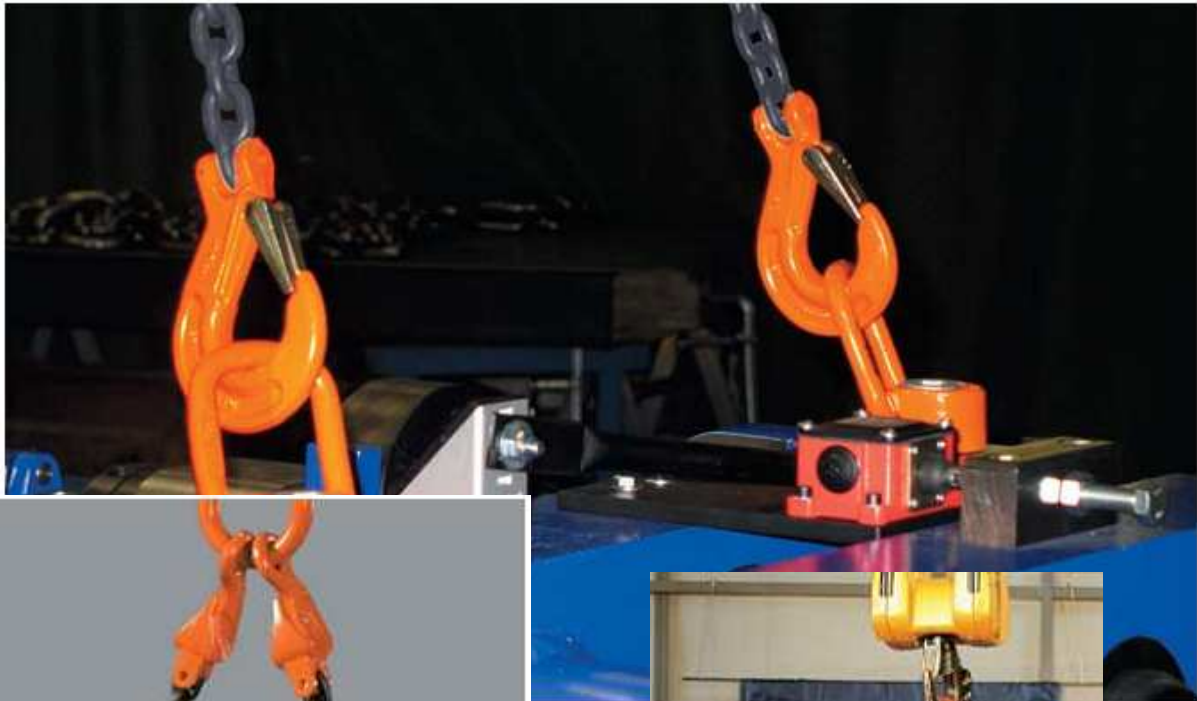

Zawiesia łańcuchowe w klasach 8 i 10

P.P.H.U. POKORA
ul. Krystyny Idzikowskiej 11
92-624 Łódź
tel./fax (042) 648 88 01
kom. 501 587 853
e-mail: biuro@pokora.com.pl
www.pokora.com.pl

Dopuszczalne obciążenia robocze

| | | 1-cięgnowe | | 2- | | | | 3- i 4-cięgnowe | | O obwodzie zamkniętym | pętlowe | |
|-------------------------|----|------------|--------|--------|---------|--------|---------|-----------------|---------|-----------------------|---------|--------|
| | | | | | | | | | | | | |
| kąć rozwarcia | | - | - | do 45° | 45°-60° | do 45° | 45°-60° | do 45° | 45°-60° | - | do 45° | 0°-45° |
| współczynnik obciążenia | | 1 | 0,8 | 1,4 | 1 | 1,12 | 0,8 | 2,1 | 1,5 | 1,6 | 1,4 | 2,1 |
| kod | d | DOR [kg] | | | | | | | | | | |
| WIN 5 G10 | 5 | 1000 | 800 | 1400 | 1000 | 1120 | 800 | 2000 | 1500 | 1600 | 1400 | 2000 |
| Ni 5 G8 | 5 | 800 | 640 | 1.120 | 800 | 900 | 640 | 1.600 | 1.180 | 1.250 | 1.120 | 1.600 |
| WIN 6 G10 | 6 | 1.400 | 1.120 | 2.000 | 1.400 | 1.600 | 1.120 | 3.000 | 2.120 | 2.240 | 2.000 | 3.000 |
| Ni 6 G8 | 6 | 1.120 | 900 | 1.600 | 1.120 | 1.250 | 900 | 2.360 | 1.700 | 1.800 | 1.600 | 2.360 |
| WIN 7 G10 | 7 | 1.900 | 1.500 | 2.650 | 1.900 | 2.120 | 1.500 | 4.000 | 2.800 | 3.000 | 2.650 | 4.000 |
| Ni 7 G8 | 7 | 1.500 | 1.200 | 2.120 | 1.500 | 1.700 | 1.200 | 3.150 | 2.240 | 2.500 | 2.120 | 3.150 |
| WIN 8 G10 | 8 | 2.500 | 2.000 | 3.550 | 2.500 | 2.800 | 2.000 | 5.300 | 3.750 | 4.000 | 3.550 | 5.300 |
| Ni 8 G8 | 8 | 2.000 | 1.600 | 2.800 | 2.000 | 2.240 | 1.600 | 4.250 | 3.000 | 3.150 | 2.800 | 4.250 |
| WIN 10 G10 | 10 | 4.000 | 3.150 | 5.600 | 4.000 | 4.250 | 3.150 | 8.000 | 6.000 | 6.300 | 5.600 | 8.000 |
| Ni 10 G8 | 10 | 3.150 | 2.500 | 4.250 | 3.150 | 3.550 | 2.500 | 6.700 | 4.750 | 5.000 | 4.250 | 6.700 |
| WIN 13 G10 | 13 | 6.700 | 5.300 | 9.500 | 6.700 | 7.500 | 5.300 | 14.000 | 10.000 | 10.600 | 9.500 | 14.000 |
| Ni 13 G8 | 13 | 5.300 | 4.250 | 7.500 | 5.300 | 5.900 | 4.250 | 11.200 | 8.000 | 8.500 | 7.500 | 11.200 |
| WIN 16 G10 | 16 | 10.000 | 8.000 | 14.000 | 10.000 | 11.200 | 8.000 | 21.200 | 15.000 | 16.000 | 14.000 | 21.200 |
| Ni 16 G8 | 16 | 8.000 | 6.300 | 11.200 | 8.000 | 9.000 | 6.300 | 17.000 | 11.800 | 12.500 | 11.200 | 17.000 |
| WIN 19 G10 | 19 | 14.000 | 11.200 | 20.000 | 14.000 | 16.000 | 11.200 | 30.000 | 21.200 | 22.400 | 20.000 | 30.000 |
| Ni 19 G8 | 19 | 11.200 | 8.950 | 16.000 | 11.200 | 12.500 | 8.950 | 23.600 | 17.000 | 18.000 | 16.000 | 23.600 |
| WIN 22 G10 | 22 | 19.000 | 15.000 | 26.500 | 19.000 | 21.200 | 15.000 | 40.000 | 28.000 | 30.000 | 26.500 | 40.000 |
| Ni 22 G8 | 22 | 15.000 | 12.000 | 21.200 | 15.000 | 17.000 | 12.000 | 31.500 | 22.400 | 23.600 | 21.200 | 31.500 |
| WIN 26 G10 | 26 | 26.500 | 21.200 | 37.500 | 26.500 | 30.000 | 21.200 | 56.000 | 40.000 | 42.500 | 37.500 | 56.000 |
| Ni 26 G8 | 26 | 21.200 | 16.950 | 30.000 | 21.200 | 23.700 | 16.950 | 45.000 | 31.500 | 33.500 | 30.000 | 45.000 |
| Ni 32 G8 | 32 | 31.500 | 25.200 | 45.000 | 31.500 | 35.200 | 25.200 | 67.000 | 47.500 | 50.000 | 45.000 | 67.000 |

Przykładowe konfiguracje zawiesi

na życzenie klienta możliwe również konfiguracje indywidualne

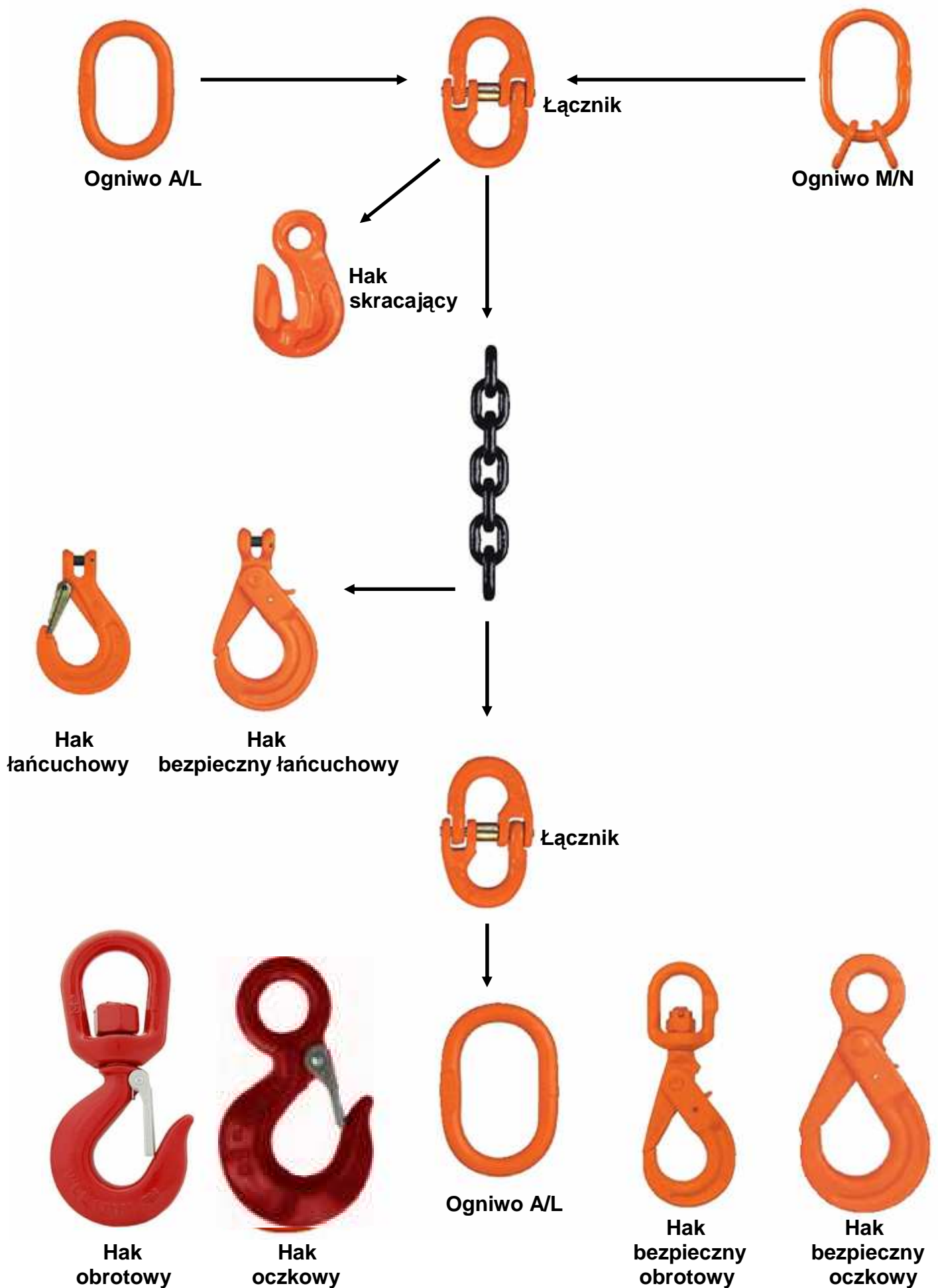

Łańcuch do zawiesi wg EN 818-2 – klasa 8

| Kod | DOR [T] | A [mm] | B [mm] | C [mm] | Waga [kg/m] |
|-------|---------|--------|--------|--------|-------------|
| Łan06 | 1,12 | 18 | 6 | 9 | 0,8 |
| Łan07 | 1,50 | 21 | 7 | 10 | 1,1 |
| Łan08 | 2,00 | 24 | 8 | 11,3 | 1,4 |
| Łan10 | 3,15 | 30 | 10 | 14,7 | 2,2 |
| Łan13 | 5,30 | 39 | 13 | 19 | 3,8 |
| Łan16 | 8,00 | 48 | 16 | 22,2 | 5,7 |
| - | 10,00 | 54 | 18 | 23,4 | 7,3 |
| - | 11,20 | 57 | 19 | 24,7 | 8,1 |
| Łan20 | 12,50 | 60 | 20 | 26 | 9,0 |
| - | 15,00 | 66 | 22 | 28,6 | 10,9 |
| - | 21,20 | 78 | 26 | 33,8 | 15,2 |
| - | 31,50 | 96 | 32 | 41,6 | 23,0 |

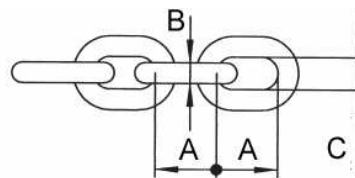

Łańcuch do zawiesi wg EN 818-2 – klasa 10

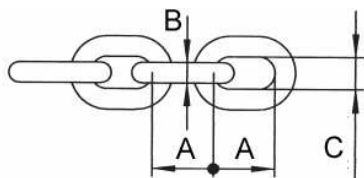

| Kod | DOR [T] | A [mm] | B [mm] | C [mm] | Waga [kg/m] |
|------------|---------|--------|--------|--------|-------------|
| WIN 5 200 | 1,0 | 16 | 5 | 7,5 | 0,61 |
| WIN 6 200 | 1,4 | 18 | 6 | 8,7 | 0,89 |
| WIN 7 200 | 1,9 | 21 | 7 | 9,5 | 1,20 |
| WIN 7 200 | 2,5 | 24 | 8 | 10,9 | 1,57 |
| WIN 10 200 | 4,0 | 30 | 10 | 13,5 | 2,46 |
| WIN 13 200 | 6,7 | 39 | 13 | 17,5 | 4,18 |
| WIN 16 200 | 10,0 | 48 | 16 | 21,5 | 6,28 |
| WIN 19 200 | 14,0 | 57 | 19 | 26,6 | 8,90 |
| WIN 22 200 | 19,0 | 66 | 22 | 29,5 | 11,88 |
| WIN 26 200 | 26,5 | 78 | 26 | 35,0 | 16,18 |

Łańcuch techniczny - ogniwa długie

UWAGA: ŁAŃCUCH NIE MOŻE BYĆ STOSOWANY W ZAWIESIACH I URZĄDZENIACH PODNOSZĄCYCH!

| Kod | Łańcuch [mm] | Min. siła zrywająca [kN] | A [mm] | B [mm] | C [mm] | Waga [kg/m] |
|--------|--------------|--------------------------|--------|--------|--------|-------------|
| ŁanT09 | 9 | 102 | 53 | 9 | 15 | 1,4 |
| ŁanT11 | 11 | 154 | 63 | 11 | 19 | 2,1 |
| ŁanT13 | 13 | 214 | 80 | 13 | 24 | 2,9 |
| - | 16 | 322 | 100 | 16 | 26 | 4,25 |

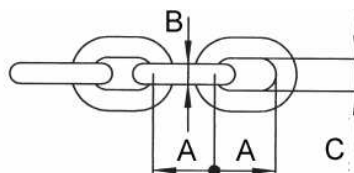

Napinacz do łańcucha

| Kod | Łańcuch [mm] | L min [mm] | L max [mm] | Waga [kg/szt] |
|----------|--------------|------------|------------|---------------|
| ŁNap0810 | 8-10 | 600 | 795 | 4,80 |
| ŁNap1013 | 10-13 | 615 | 820 | 5,60 |

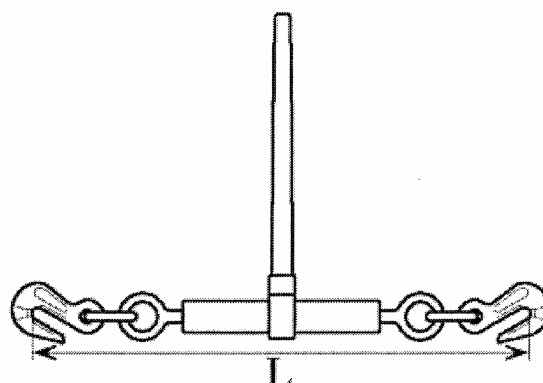

Łącznik do łańcucha – klasa 8

| Kod | Kod | Łańcuch [mm] | DOR [T] | A [mm] | B [mm] | C [mm] | D [mm] | E [mm] | Waga [kg/szt] |
|---------|----------|--------------|---------|--------|--------|--------|--------|--------|---------------|
| ŁCon06 | ŁQCon06 | 6 | 1,12 | 40 | 14,5 | 8 | 17 | 44 | 0,1 |
| ŁCon078 | ŁQCon078 | 7;8 | 2,00 | 53 | 20 | 10 | 20 | 54 | 0,2 |
| ŁCon10 | ŁQCon10 | 10 | 3,20 | 67 | 25 | 11 | 24 | 68 | 0,3 |
| ŁCon13 | - | 13 | 5,40 | 83 | 30 | 15 | 32 | 84 | 0,7 |
| ŁCon16 | - | 16 | 8,00 | 101 | 36 | 19 | 44 | 105 | 1,1 |
| - | - | 18 | 10,00 | 122 | 44 | 22 | 46 | 125 | 1,8 |
| ŁCon20 | - | 20 | 12,50 | 122 | 44 | 22 | 46 | 125 | 1,8 |
| - | - | 22 | 15,00 | 140 | 55 | 26 | 51 | 130 | 2,9 |
| - | - | 26 | 21,20 | 165 | 65 | 32 | 60 | 170 | 4,6 |
| - | - | 32 | 32,00 | 185 | 80 | 38 | 63 | 191 | 8,3 |

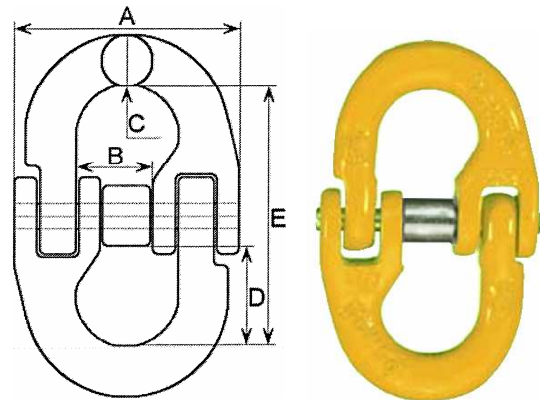

Łącznik do łańcucha – klasa 10

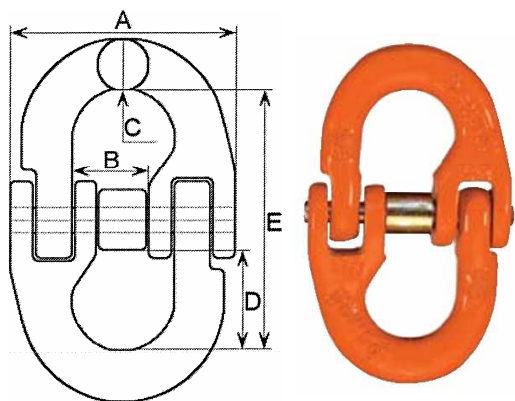

| Kod | Kod | Łańcuch [mm] | DOR [T] | A [mm] | B [mm] | C [mm] | E [mm] | Waga [kg/szt] |
|---------|----------|--------------|---------|--------|--------|--------|--------|---------------|
| ŁCon06 | ŁQCon06 | 6 | 1,40 | 39,0 | 14,1 | 7,8 | 44,4 | 0,06 |
| ŁCon078 | ŁQCon078 | 7;8 | 1,90 | 46,5 | 17,1 | 10,0 | 51,0 | 0,12 |
| ŁCon10 | ŁQCon10 | 10 | 4,00 | 63 | 23,0 | 12,6 | 72,0 | 0,33 |
| ŁCon13 | - | 13 | 6,70 | 79 | 27,6 | 19,0 | 88,0 | 0,70 |
| ŁCon16 | - | 16 | 10,0 | 106 | 33,0 | 21,0 | 103 | 1,14 |
| - | - | 18 | ? | | | | | |
| ŁCon20 | - | 20 | 16,0 | 118 | 1,7 | 29,5 | 115 | 2,14 |
| - | - | 22 | 19,0 | 148 | 51 | 34 | 161 | 4,10 |
| - | - | 26 | 26,5 | 175 | 60 | 40 | 190 | 6,70 |
| - | - | 32 | 31,5 | 195 | 80 | 40 | 194 | 8,46 |

Ogniwo A wg DIN 5688-3 do zawiesi łańcuchowych jedno- i dwucięgowych – klasa 8

| Kod | Ogniwo rozmiar | DOR [T] | Łańcuch zaw. 1-cięgn. [mm] | Łańcuch zaw. 2-cięgn. [mm] | A [mm] | B [mm] | C [mm] | Waga [kg/szt] |
|--------|----------------|---------|----------------------------|----------------------------|--------|--------|--------|---------------|
| OgnA13 | A13 | 1,6 | 6-7 | 6 | 86 | 60 | 110 | 0,34 |
| OgnA16 | A16 | 3,2 | 8 | 7 | 92 | 60 | 110 | 0,53 |
| OgnA18 | A18 | 4,0 | 10 | 8 | 111 | 75 | 135 | 0,80 |
| OgnA22 | A22 | 6,4 | 13 | 10 | 134 | 90 | 160 | 1,50 |
| OgnA26 | A26 | 10,0 | 16 | 13 | 154 | 102 | 180 | 2,30 |
| OgnA32 | A32 | 16,0 | 18 | 16 | 176 | 112 | 200 | 3,90 |
| OgnA36 | A36 | 20,0 | 20/22 | 18 | 212 | 140 | 260 | 6,35 |
| OgnA40 | A40 | 25,0 | - | 20 | 240 | 160 | 300 | 9,00 |
| - | A45 | 30,0 | 26 | 22 | 270 | 180 | 340 | 12,8 |
| - | A51 | 40,0 | 32 | 26 | 292 | 190 | 350 | 17,2 |
| - | A57 | 64,0 | 36 | 32 | 314 | 200 | 400 | 24,3 |
| - | A63 | 80,0 | 40 | 36 | 346 | 220 | 430 | 32,0 |
| - | A72 | 100,0 | 45 | 40 | 394 | 250 | 460 | 46,0 |
| - | A80 | 126,0 | - | 45 | 430 | 270 | 500 | 62,0 |

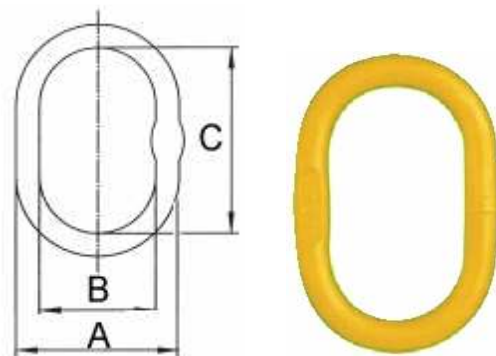

Ogniwo AW wg DIN 5688-3 do zawiesi łańcuchowych jedno- i dwucięgowych – klasa 10

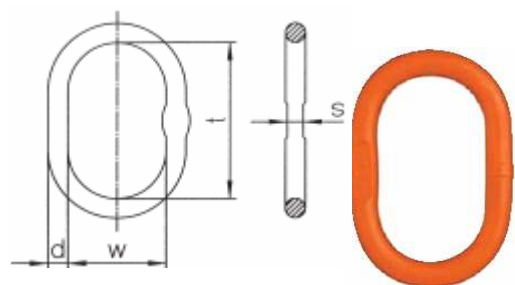

| Kod | DOR [T] | Łańcuch zaw. 1-cięgn. [mm] | Łańcuch zaw. 2-cięgn. [mm] | Łańcuch zaw. 3/4-cięgn. [mm] | d [mm] | s [mm] | w [mm] | t [mm] | Waga [kg/szt] |
|------|---------|----------------------------|----------------------------|------------------------------|--------|--------|--------|--------|---------------|
| AW10 | 1,4 | 5 | 5 | - | 10 | 10 | 50 | 80 | 0,14 |
| AW13 | 2,3 | 6+7 | 6 | 5 | 13 | 10 | 60 | 110 | 0,34 |
| AW16 | 3,5 | 8 | 7 | - | 16 | 14 | 60 | 110 | 0,53 |
| AW18 | 5,0 | 10 | 8 | 6 | 19 | 14 | 75 | 135 | 0,92 |
| AW22 | 7,6 | 13 | 10 | 7-8 | 23 | 17 | 90 | 160 | 1,60 |
| AW26 | 10,0 | 16 | 13 | 10 | 27 | 20 | 100 | 180 | 2,46 |
| AW32 | 14,0 | 19 | 16 | 13 | 33 | 26 | 10 | 200 | 4,14 |
| AW36 | 25,1 | 22 | 19 | 16 | 36 | | 140 | 260 | 6,22 |
| AW45 | 30,8 | 26 | 22 | - | 45 | | 180 | 340 | 12,82 |
| AW50 | 40,0 | 32 | 26 | 19-22 | 50 | | 190 | 350 | 16,55 |
| AW56 | 60,0 | - | 32 | 26 | 60 | | 200 | 400 | 27,01 |
| A72 | 81,5 | - | - | 32 | 70 | | 250 | 460 | 45,00 |

Ogniwo L powiększone do zawiesi linowych i łańcuchowych jedno- i dwucięgnowych – klasa 8

Także do zawiesi linowych

| Kod | Kod | Ogniwo rozmiar | DOR [T] | | Łańcuch Zaw. 1-c [mm] | Łańcuch Zaw. 2-c [mm] | A [mm] | B [mm] | C [mm] | Waga [kg/szt] |
|--------|--------|----------------|---------|------|-----------------------|-----------------------|--------|--------|--------|---------------|
| | | | 5:1 | 4:1 | | | | | | |
| OgnL13 | OgQL13 | LSA13 | 1,35 | 1,70 | 6-7 | 6 | 96 | 70 | 120 | 0,38 |
| OgnL16 | - | LSA16 | 2,50 | 3,00 | 8 | - | 109 | 77 | 130 | 0,62 |
| OgnL18 | - | LSA18 | 3,00 | 3,60 | 8 | 7 | 129 | 93 | 154 | 0,92 |
| OgnL20 | - | LSA20 | 3,60 | 4,50 | 10 | 8 | 140 | 100 | 160 | 1,22 |
| OgnL22 | - | LSA22 | 4,30 | 5,40 | 13 | 8 | 154 | 110 | 167 | 1,59 |
| OgnL26 | - | LSA26 | 7,00 | 8,80 | 16 | 10 | 170 | 118 | 187 | 2,47 |
| OgnL28 | - | LSA28 | 8,65 | 10,8 | 18 | 13 | 176 | 120 | 200 | 3,02 |
| OgnL30 | - | LSA30 | 10,0 | 12,5 | 20 | 13 | 185 | 125 | 210 | 3,64 |
| OgnL32 | - | LSA32 | 11,5 | 14,5 | 20 | 13 | 194 | 130 | 220 | 4,35 |
| - | - | LSA40 | 16,8 | 21,0 | 22 | 16-18 | 250 | 170 | 260 | 8,28 |
| - | - | LSA44 | 20,8 | 26,0 | 26 | 20 | 268 | 180 | 280 | 10,78 |
| - | - | LSA50 | 26,4 | 33,0 | 32 | 22 | 300 | 200 | 315 | 15,65 |

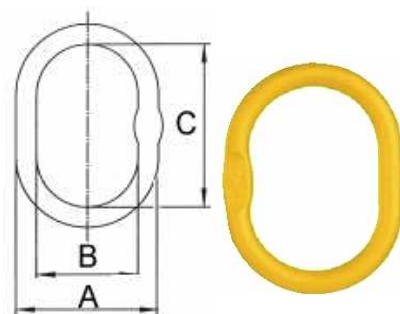

Ogniwo L powiększone do zawiesi linowych i łańcuchowych jedno- i dwucięgnowych – klasa 10

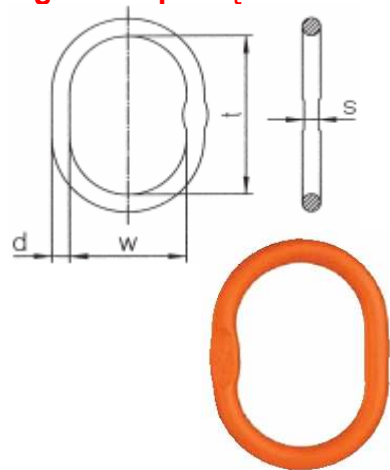

| Kod | Ogniwo rozmiar | Łańcuch Zaw. 1-c [mm] | Łańcuch Zaw. 2-c [mm] | Łańcuch Zaw. 3/4-c [mm] | A [mm] | B [mm] | C [mm] | Waga [kg/szt] |
|--------|----------------|-----------------------|-----------------------|-------------------------|--------|--------|--------|---------------|
| MW 10 | 11 | 5 | 5 | - | 96 | 70 | 120 | 0,38 |
| MW 13 | 14 | 6-7 | 6 | 5 | 109 | 77 | 130 | 0,62 |
| MW 16 | 16 | 8 | 7 | - | 129 | 93 | 154 | 0,92 |
| MW 18 | 19 | 10 | 8 | 6 | 140 | 100 | 160 | 1,22 |
| MW 22 | 23 | 13 | 10 | 7-8 | 154 | 110 | 167 | 1,59 |
| MW 26 | 27 | 16 | 13 | 10 | 170 | 118 | 187 | 2,47 |
| MW 32 | 33 | 19 | 16 | 13 | 176 | 120 | 200 | 3,02 |
| MW 36 | 38 | 22 | 19 | 16 | 185 | 125 | 210 | 3,64 |
| MW 56 | 56 | 32 | 26 | 19-22 | 194 | 130 | 220 | 4,35 |
| SAW 32 | 33 | - | - | - | 250 | 170 | 260 | 8,28 |
| SAW 45 | 45 | - | - | - | 268 | 180 | 280 | 10,78 |
| SAW 60 | 60 | - | - | - | 300 | 200 | 315 | 15,65 |

Ogniwo M wg DIN 5688-3 do zawiesi łańcuchowych trzy- i czterocięgnowych – klasa 8

| Kod | Kod | Ogniwo rozmiar | DOR [T] | Łańcuch zaw. 3-4cięgn [mm] | A [mm] | B [mm] | C [mm] | D [mm] | E [mm] | F [mm] | Waga [kg/szt] |
|----------|----------|----------------|---------|----------------------------|--------|--------|--------|--------|--------|--------|---------------|
| OgnM1813 | - | 18-13 | 6,50 | 6-7 | 115 | 79 | 132 | 51 | 54 | 24 | 1,16 |
| OgnM2216 | OgQM2216 | 22-16 | 8,00 | 8 | 136 | 92 | 156 | 66 | 70 | 33 | 2,22 |
| OgnM2618 | OgQM2618 | 26-18 | 12,8 | 10 | 154 | 102 | 180 | 76 | 85 | 40 | 3,36 |
| OgnM3222 | OgQM3222 | 32-33 | 20,0 | 13 | 174 | 110 | 200 | 94 | 115 | 50 | 6,02 |
| OgnM3626 | - | 36-26 | 32,0 | 16 | 212 | 140 | 260 | 117 | 140 | 65 | 9,94 |
| - | - | 45-32 | 40,0 | 18 | 270 | 180 | 340 | 134 | 150 | 70 | 18,9 |
| OgnM5132 | - | 51-32 | 50,0 | 20 | 292 | 190 | 350 | 134 | 150 | 70 | 23,3 |
| - | - | 51-36 | 60,0 | 22 | 292 | 190 | 350 | 147 | 170 | 75 | 25,8 |
| - | - | 57-40 | 80,0 | 26 | 314 | 200 | 400 | 160 | 170 | 80 | 35,2 |
| - | - | 63-45 | 96,0 | 28 | 346 | 220 | 430 | 180 | 180 | 90 | 47,0 |

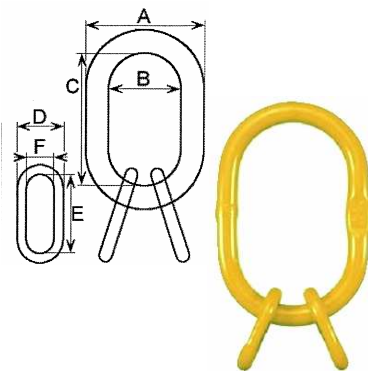

Ogniwo przejściowe BW do ogniw zbiorczych – klasa 10

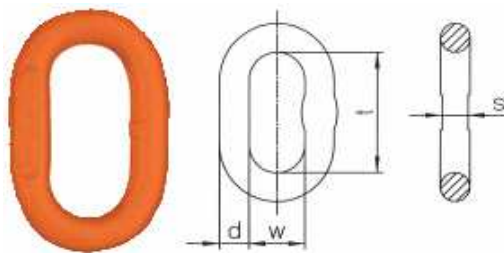

| Kod | DOR [T] | d [mm] | t [mm] | w [mm] | Ogniwo do łańcucha o śr. | | Waga [kg/szt] |
|-------|---------|--------|--------|--------|--------------------------|-------|---------------|
| | | | | | 1-2c. | 3-4c. | |
| BW 7 | 1,0 | 36 | 16 | 7 | 5 | - | 0,03 |
| BW 8 | 1,4 | 36 | 16 | - | 6 | - | 0,03 |
| BW 9 | 1,9 | 44 | 20 | - | 7 | - | 0,07 |
| BW 10 | 2,5 | 44 | 20 | - | 8 | 5 | 0,09 |
| BW 13 | 4,0 | 54 | 25 | 10 | 10 | 6 | 0,17 |
| BW 16 | 6,7 | 70 | 34 | 14 | 13 | 7-8 | 0,36 |
| BW 20 | 10,0 | 85 | 40 | - | 16 | 10 | 0,68 |
| BW 22 | 12,5 | 115 | 50 | 17 | - | 13 | 1,16 |
| BW 23 | 14,0 | 115 | 45 | 17 | 19 | - | 1,15 |
| BW 26 | 16,2 | 140 | 65 | 20 | - | 16 | 1,92 |
| BW 27 | 19,0 | 140 | 55 | 20 | 22 | - | 1,92 |
| BW 32 | 26,5 | 150 | 70 | 26 | 26 | 19 | 3,16 |
| BW 36 | 31,0 | 170 | 75 | - | - | 22 | 4,12 |
| BW 40 | 40,4 | 170 | 80 | - | 32 | - | 5,37 |
| BW 45 | 42,4 | 170 | 80 | - | - | 26 | 7,15 |
| B 50 | 58,0 | 200 | 100 | - | - | 32 | 10,8 |

Ogniwo M wg DIN 5688-3 do zawiesi łańcuchowych trzy- i czterocięgnowych – klasa 10

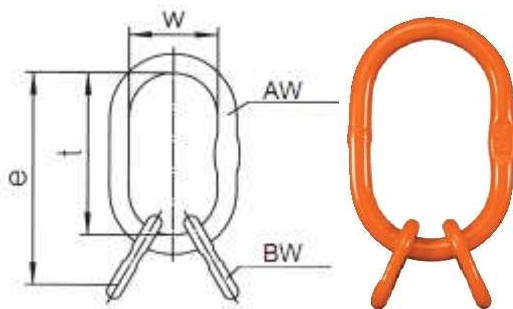

| Kod | Elementy składowe | DOR [T] | e [mm] | t [mm] | w [mm] | Waga [kg/szt] |
|---------|-------------------|---------|--------|--------|--------|---------------|
| M 5 | AW 13 + 2 BW 10 | 2,3 | 154 | 110 | 60 | 0,52 |
| M 6 | AW 18 + 2 BW 13 | 4,2 | 189 | 135 | 75 | 1,26 |
| M 7/8 | AW 22 + 2 BW 16 | 7,6 | 230 | 160 | 90 | 2,32 |
| M 10 | AW 26 + 2 BW 20 | 9,6 | 265 | 180 | 100 | 3,68 |
| M 13 | AW 32 + 2 BW 22 | 14,0 | 315 | 200 | 110 | 6,46 |
| M 16 | AW 36 + 2 BW 26 | 21,2 | 400 | 260 | 140 | 10,06 |
| M 19/20 | AW 50 + 2 BW 36 | 34,1 | 500 | 350 | 190 | 22,87 |
| M 22 | AW 50 + 2 BW 36 | 40,0 | 520 | 350 | 190 | 24,79 |
| M 26 | AW 56 + 2 BW 45 | 56,0 | 570 | 400 | 200 | 41,31 |
| M 32 | A 72 + 2 B 50 | 76,0 | 660 | 460 | 250 | 66,6 |

Ogniwo N powiększone do zawiesi łańcuchowych trzy- i czterocięgnowych – klasa 8 Także do zawiesi linowych

| Kod | Ogniwo rozmiar | DOR [T] | Łańcuch zaw. 3-4cięgn. [mm] | A [mm] | B [mm] | C [mm] | D [mm] | E [mm] | F [mm] | Waga [kg/szt] |
|----------|----------------|---------|-----------------------------|--------|--------|--------|--------|--------|--------|---------------|
| OgnN2014 | 20-14 | 5,5 | 7 | 135 | 95 | 160 | 98 | 120 | 70 | 2,90 |
| OgnN2216 | 22-16 | 6,0 | 7 | 134 | 90 | 160 | 66 | 70 | 34 | 2,65 |
| OgnN2618 | 26-18 | 9,0 | 8 | 152 | 100 | 180 | 76 | 85 | 40 | 4,07 |
| OgnN3022 | 30-22 | 12,5 | 10 | 174 | 110 | 200 | 94 | 115 | 50 | 6,64 |
| OgnN3222 | 32-22 | 15,0 | 10 | 212 | 140 | 260 | 117 | 140 | 65 | 7,35 |
| OgnN3626 | 36-26 | 22,0 | 13 | 270 | 180 | 340 | 134 | 150 | 70 | 10,95 |

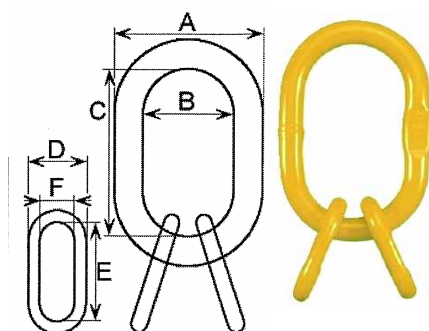

Ogniwo N powiększone do zawiesi łańcuchowych trzy- i czterocięgnowych – klasa 10 Także do zawiesi linowych

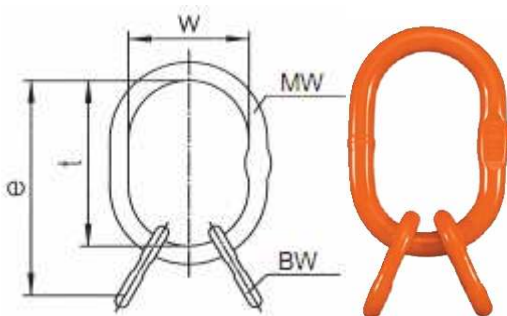

| Kod | Elementy składowe | DOR [T] | e [mm] | t [mm] | w [mm] | Waga [kg/szt] |
|-----------|-------------------|---------|--------|--------|--------|---------------|
| VMW 6 | MW 18 + 2 BW 13 | 4,2 | 214 | 160 | 95 | 1,43 |
| VMW 7/8 | MW 22 + 2 BW 16 | 6,6 | 230 | 160 | 110 | 2,41 |
| VMW 10 | MW 26 + 2 BW 20 | 10,1 | 275 | 190 | 110 | 4,01 |
| VMW 13 | MW 32 + 2 BW 22 | 15,7 | 345 | 230 | 130 | 6,90 |
| VMW 16 | MW 36 + 2 BW 26 | 21,2 | 415 | 275 | 150 | 11,12 |
| VMW 19/20 | MW 56 + 2 BW 32 | 34,1 | 500 | 350 | 250 | 28,08 |
| VMW 22 | MW 56 + 2 BW 36 | 40,0 | 520 | 350 | 250 | 30,62 |

Szafka wzmocniona okrągła Także do zawiesi linowych

| Szafka A | | Szafka C | | DOR [T] | A [mm] | B [mm] | C [mm] | D [mm] | H [mm] | L [mm] | R [mm] |
|----------|-------|----------|------|---------|--------|--------|--------|--------|--------|--------|--------|
| Kod | Waga | Kod | Waga | | | | | | | | |
| - | 0,09 | - | 0,14 | 0,75 | 9 | 19 | 53 | 10 | 31 | 13,5 | 10,5 |
| SzaTA10 | 0,13 | - | 0,18 | 1,00 | 10 | 25 | 63,5 | 11 | 36,6 | 16 | 13 |
| SzaTA15 | 0,20 | - | 0,26 | 1,50 | 11 | 27 | 74 | 12 | 42,9 | 18,5 | 14,5 |
| SzaTA20 | 0,32 | SzaTC20 | 0,36 | 2,00 | 13 | 31 | 84 | 16 | 47 | 22 | 17,5 |
| SzaT32 | 0,61 | SzaTC32 | 0,75 | 3,25 | 16,5 | 40 | 106 | 20 | 57 | 29 | 22 |
| SzaTA47 | 1,05 | SzaTC47 | 1,15 | 4,75 | 20 | 48 | 126 | 22 | 69 | 34 | 26 |
| SzaTA65 | 1,56 | SzaTC65 | 1,87 | 6,50 | 22 | 54 | 146 | 25 | 83 | 37 | 29 |
| SzaTA85 | 2,25 | SzaTC85 | 2,79 | 8,50 | 26 | 60 | 165 | 28 | 95 | 44 | 34 |
| - | 3,20 | - | 3,58 | 9,50 | 28 | 67 | 185 | 33 | 108 | 46 | 37 |
| SzaTA1 | 4,60 | SzaTC92 | 4,87 | 12,0 | 33 | 76 | 210 | 36 | 117 | 54 | 42 |
| - | 5,80 | - | 6,36 | 13,5 | 35 | 84 | 229 | 40 | 132 | 57 | 46 |
| SzaTA1 | 7,40 | SzaTC97 | 8,60 | 17,0 | 38 | 92 | 251 | 42 | 146 | 61 | 49 |
| - | 12,80 | - | 14,2 | 25,0 | 45 | 110 | 303 | 48 | 179 | 75 | 64 |
| - | 18,20 | - | 20,7 | 35,0 | 50 | 128 | 341 | 60 | 197 | 85 | 73,5 |

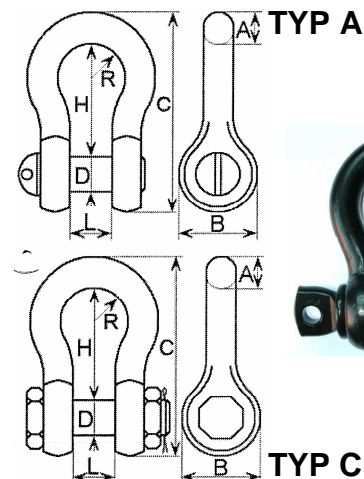

Hak oczkowy ze stali węglowej (CARBON) lub stopowej (ALLOY), z zabezpieczeniem – klasa 8 Także do zawiesi linowych

| Stal węglowa CARBON | | Stal stopowa ALLOY | | A [mm] | B [mm] | C [mm] | H [mm] | L [mm] | S [mm] | S1 [mm] | X1 [mm] | X2 [mm] | Waga [kg/szt] |
|------------------------|------------|-----------------------|------------|-----------|-----------|-----------|-----------|-----------|-----------|------------|------------|------------|------------------|
| Kod | DOR [T] | Kod | DOR [T] | | | | | | | | | | |
| HTLC08 | 0,8 | HTLA12 | 1,25 | 72 | 38 | 18 | 81 | 110 | 27 | 21 | 21 | 15 | 0,28 |
| HTLC10 | 1,0 | HTLA16 | 1,60 | 81 | 46 | 23 | 93 | 126 | 28 | 22 | 24 | 18,5 | 0,39 |
| HTLC16 | 1,6 | HTLA25 | 2,50 | 88 | 53 | 28 | 106 | 142 | 30 | 24 | 30,5 | 19,5 | 0,62 |
| HTLC20 | 2,0 | HTLA32 | 3,20 | 103 | 62 | 32 | 123 | 167 | 33 | 28 | 33,5 | 23 | 0,91 |
| HTLC32 | 3,2 | HTLA54 | 5,40 | 121 | 76 | 40 | 146 | 201 | 40 | 33 | 41,5 | 29 | 1,65 |
| HTLC50 | 5,0 | HTLA80 | 8,00 | 156 | 102 | 51 | 190 | 265 | 47 | 40 | 53 | 35,5 | 3,95 |
| HTLC75 | 7,5 | HTLA91 | 11,5 | 195 | 120 | 62 | 230 | 325 | 52 | 52 | 67 | 43 | 6,46 |
| HTLC90 | 10,0 | HTLA96 | 16,0 | 210 | 138 | 72 | 260 | 357 | 62 | 62 | 75 | 51 | 9,00 |
| HTLC95 | 15,0 | HTLA992 | 22,0 | 284 | 169 | 89 | 320 | 438 | 79 | 79 | 90,5 | 63 | 17,6 |

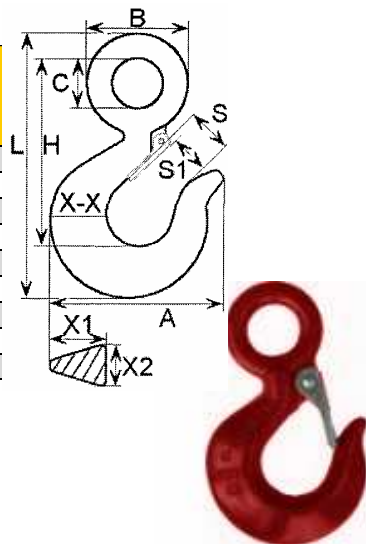

Hak obrotowy ze stali węglowej (CARBON) lub stopowej (ALLOY) z zabezpieczeniem – klasa 8 Także do zawiesi linowych

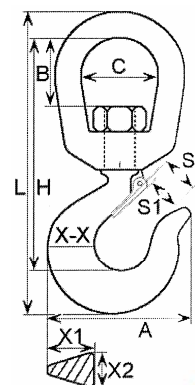

| Stal węglowa CARBON | | Stal stopowa ALLOY | | A [mm] | B [mm] | C [mm] | H [mm] | L [mm] | S [mm] | S1 [mm] | X1 [mm] | X2 [mm] | Waga [kg/szt] |
|------------------------|------------|-----------------------|------------|-----------|-----------|-----------|-----------|-----------|-----------|------------|------------|------------|------------------|
| Kod | DOR [T] | Kod | DOR [T] | | | | | | | | | | |
| - | - | HTOA10 | 1,0 | 75 | 41 | 39 | 136 | 173 | 27 | 20 | 21 | 15 | 0,69 |
| HTOC10 | 1,0 | HTOA15 | 1,5 | 81 | 34 | 39 | 141 | 180 | 28 | 21 | 24 | 18,5 | 0,81 |
| HTOC15 | 1,5 | HTOA20 | 2,0 | 92 | 53 | 47 | 164 | 207 | 30 | 24 | 30,5 | 19,5 | 1,25 |
| HTOC20 | 2,0 | HTOA30 | 3,0 | 103 | 55 | 47 | 176 | 225 | 33 | 28 | 33,5 | 23 | 1,45 |
| - | 3,2 | HTOA45 | 4,5 | 126 | 65 | 64 | 216 | 275 | 38 | 33 | 41,5 | 29 | 3,10 |
| - | 5,0 | HTOA70 | 7,0 | 166 | 82 | 77 | 280 | 355 | 47 | 41 | 53 | 35,5 | 6,10 |
| - | 7,5 | HTOA91 | 11,0 | 195 | 85 | 90 | 320 | 410 | 58 | 47 | 67 | 43 | 10,00 |
| - | 10,0 | HTOA95 | 15,0 | 223 | 95 | 96 | 360 | 465 | 65 | 57 | 75 | 51 | 15,22 |



Hak łańcuchowy do zawiesi łańcuchowych – klasa 8

| Kod | Łańcuch [mm] | DOR [mm] | A [mm] | B [mm] | C [mm] | D [mm] | E [mm] | F [mm] | H [mm] | L [mm] | S [mm] | Waga [kg/szt] |
|-------|-----------------|-------------|-----------|-----------|-----------|-----------|-----------|-----------|-----------|-----------|-----------|------------------|
| HTŁ20 | 7-8 | 2,0 | 93 | 38 | 9 | 22 | 30 | 22 | 97 | 143 | 27,5 | 0,82 |
| HTŁ32 | 10 | 3,2 | 110 | 45,5 | 11,5 | 24 | 32 | 32 | 125 | 175 | 35 | 1,40 |
| HTŁ54 | 13 | 5,4 | 137 | 60,5 | 14,5 | 32 | 44 | 32 | 141 | 214 | 38,7 | 2,40 |
| - | 16 | 8 | 168 | 68 | 18 | 40 | 51,5 | 38,2 | - | 260 | 48,4 | 4,10 |

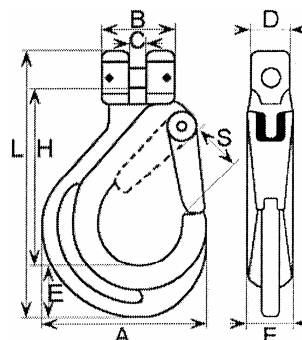

Hak łańcuchowy do zawiesi łańcuchowych – klasa 10

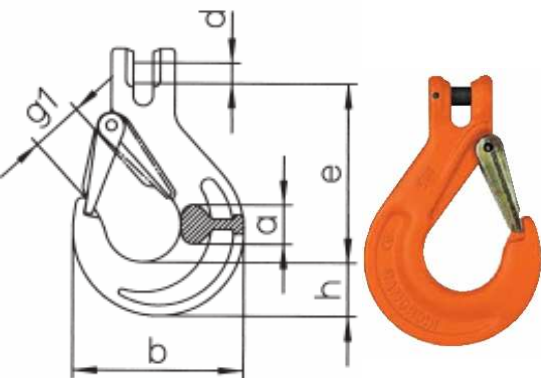

| Kod | DOR [T] | e [mm] | h [mm] | a [mm] | d [mm] | g1 [mm] | b [mm] | Waga [kg/szt] |
|------------|---------|--------|--------|--------|--------|---------|--------|---------------|
| KHSW 5/6 | 1,4 | 69 | 20 | 15 | 7,4 | 19 | 66 | 0,20 |
| KHSW 7 | 1,9 | 95 | 28 | 19 | 9,0 | 26 | 90 | 0,60 |
| KHSW 8 | 2,5 | 94,5 | 28 | 19 | 10,0 | 26 | 90 | 0,60 |
| KHSW 10 | 4,0 | 109 | 34,5 | 25 | 12,5 | 31 | 108 | 1,10 |
| KHSW 13 | 6,7 | 136 | 41 | 34 | 16,0 | 39 | 131 | 2,00 |
| KHSW16 | 10,0 | 155 | 49 | 37 | 20,0 | 45 | 153 | 3,48 |
| KHSW 19/20 | 16,0 | 183,5 | 53 | 51 | 24,0 | 53 | 177 | 5,00 |
| KHSW 22 | 19,0 | 213,5 | 62 | 52 | 27,0 | 62 | 196 | 9,00 |

Zabezpieczenie do haków HTLxxx, HTOxxx, HTŁxx

| Kod | Rozmiar nominalny | Do haków o rozmiarach | A [mm] | B [mm] | C [mm] | D [mm] | E [mm] | Waga [kg/szt] |
|---------|-------------------|--------------------------------------|--------|--------|--------|--------|--------|---------------|
| HZ05-15 | 05-15 | HTLC08,10; HTLC12,16 | 16 | 20 | 15 | 41 | 34 | 0,02 |
| HZ25-35 | 25-35 | HTLC16,20; HTLA25,32; HTŁ20,32 | 20 | 24 | 16 | 49 | 41 | 0,03 |
| HZ45 | 45 | HTLC32; HTLA54; HTŁ54 | 23 | 28 | 20 | 62 | 51 | 0,06 |
| HZ55-65 | 55-65 | HTLC50,75; HTLA80,91 | 29 | 35 | 25 | 87 | 76 | 0,11 |
| HZ75 | 75 | HTLC90; HTLA96 | 39 | 45 | 25 | 97 | 86 | 0,15 |
| HZ85 | 85 | HTLC95; HTLA992 | 44 | 50 | 30 | 131 | 115 | 0,25 |

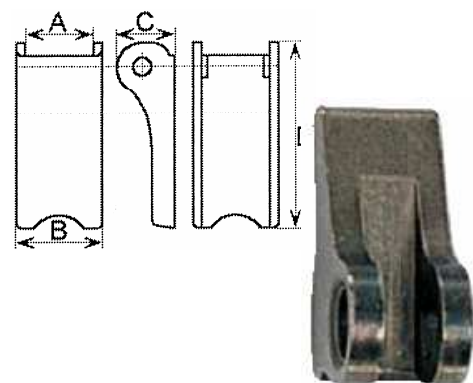

Hak bezpieczny oczkowy – klasa 8

Także do zawiesi linowych

| Kod | Kod | Łańcuch [mm] | DOR [T] | | A [mm] | B [mm] | C [mm] | H [mm] | L [mm] | S [mm] | Waga [kg/szt] |
|-------|-------|--------------|---------|-----|--------|--------|--------|--------|--------|--------|---------------|
| | | | 4:1 | 5:1 | | | | | | | |
| HTB12 | - | 6 | 1,12 | 0,9 | 72 | 44 | 21 | 110 | 140 | 36 | 0,50 |
| HTB20 | - | 7-8 | 2,0 | 1,6 | 86 | 46 | 24 | 132 | 170 | 38 | 0,83 |
| HTB32 | HQB32 | 10 | 3,2 | 2,6 | 110 | 63 | 32 | 170 | 220 | 47 | 1,68 |
| HTB54 | HQB54 | 13 | 5,4 | 4,3 | 137 | 81 | 40 | 210 | 270 | 67 | 3,10 |
| HTB80 | - | 16 | 8,0 | 6,4 | 171 | 98 | 50 | 255 | 332 | 81 | 5,90 |

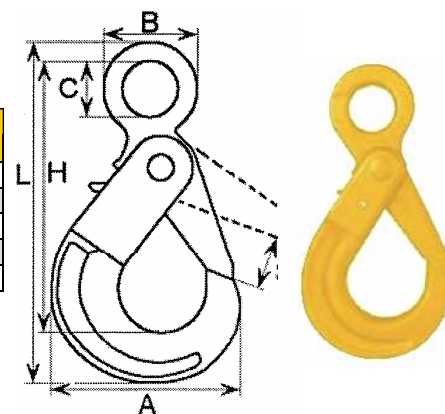

Hak bezpieczny oczkowy – klasa 10

Także do zawiesi linowych

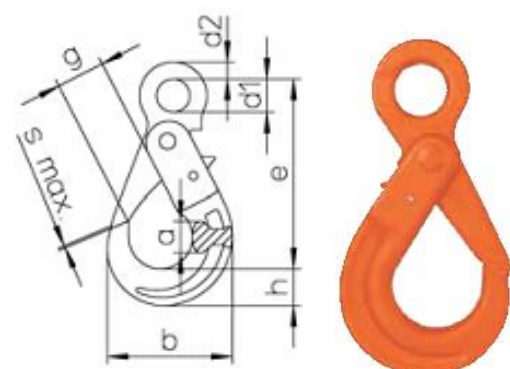

| Kod | DOR [T] | e [mm] | h [mm] | a [mm] | b [mm] | d1 [mm] | d2 [mm] | g [mm] | s max. [mm] | Waga [kg/szt] |
|-----------|---------|--------|--------|--------|--------|---------|---------|--------|-------------|---------------|
| LHW 5/6 | 1,4 | 110 | 20 | 17 | 71 | 21 | 11 | 28 | 1,0 | 0,5 |
| LHW 7/8 | 2,5 | 136 | 26 | 20 | 88 | 25 | 12 | 34 | 1,0 | 0,9 |
| LHW 10 | 4,0 | 169 | 30 | 29 | 107 | 34,5 | 15 | 45 | 1,0 | 1,5 |
| LHW 13 | 6,7 | 205 | 40 | 35 | 138 | 40 | 20 | 52 | 1,5 | 2,7 |
| LHW 16 | 10,0 | 251 | 50 | 41 | 168 | 50 | 27 | 60 | 2,0 | 5,7 |
| LHW 19/20 | 16,0 | 290 | 62 | 50 | 194 | 60 | 30 | 70 | 2,0 | 9,8 |
| LHW 22 | 19,0 | 322 | 65 | 52 | 211 | 70 | 32 | 81 | 2,0 | 12,4 |

Hak bezpieczny obrotowy – klasa 8

Także do zawiesi linowych

| Kod | Łańcuch [mm] | DOR [T] | | A [mm] | B [mm] | C [mm] | H [mm] | L [mm] | S [mm] | Waga [kg/szt] |
|--------|--------------|---------|-----|--------|--------|--------|--------|--------|--------|---------------|
| | | 4:1 | 5:1 | | | | | | | |
| HTBO20 | 7-8 | 2,0 | 1,6 | 86 | 30 | 37 | 190 | 225 | 38 | 1,1 |
| HTBO32 | 10 | 3,2 | 2,6 | 110 | 36 | 42 | 226 | 270 | 47 | 2,0 |
| HTBO54 | 13 | 5,4 | 4,3 | 137 | 47 | 47 | 340 | 340 | 62 | 4,0 |

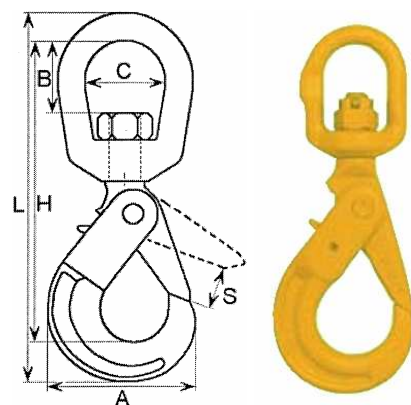

Hak bezpieczny obrotowy – klasa 10

Także do zawiesi linowych

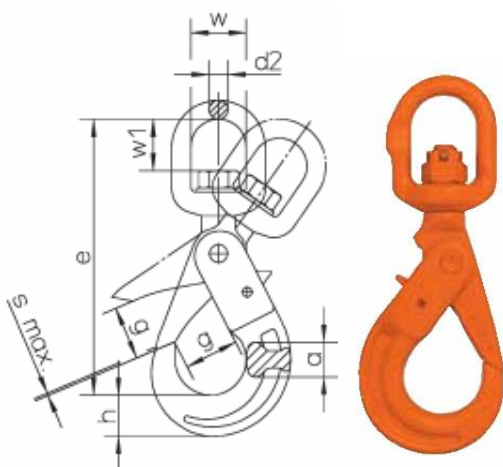

| Kod | DOR [T] | e [mm] | h [mm] | a [mm] | w [mm] | w1 [mm] | d2 [mm] | g [mm] | s max. [mm] | Waga [kg/szt] |
|--|---------|--------|--------|--------|--------|---------|---------|--------|-------------|---------------|
| WLHW 6 | 1,4 | 160 | 20 | 17 | 35 | 35 | 13 | 28 | 1,0 | 0,6 |
| WLHW 7/8 | 2,5 | 181 | 26 | 20 | 35 | 35 | 13 | 34 | 1,0 | 1,1 |
| WLHW 10 | 4,0 | 218 | 30 | 29 | 42 | 40 | 16 | 45 | 1,0 | 2,0 |
| WLHW 13 | 6,7 | 269 | 40 | 35 | 49 | 47 | 20 | 52 | 1,5 | 4,0 |
| WLHW 16 | 10,0 | 319 | 50 | 41 | 60 | 60 | 24 | 60 | 2,0 | 6,8 |
| Hak standardowy WLHW nie może być obracany pod obciążeniem! | | | | | | | | | | |
| WLHBW 6 | 1,4 | 160 | 20 | 17 | 35 | 35 | 13 | 28 | 1,0 | 0,6 |
| WLHBW 7/8 | 2,5 | 181 | 26 | 20 | 35 | 35 | 13 | 34 | 1,0 | 1,1 |
| WLHBW 10 | 4,0 | 218 | 30 | 29 | 42 | 40 | 16 | 45 | 1,0 | 2,0 |
| WLHBW 13 | 6,7 | 269 | 40 | 35 | 49 | 47 | 20 | 52 | 1,5 | 4,0 |
| WLHBW 16 | 10,0 | 319 | 50 | 41 | 60 | 60 | 24 | 60 | 2,0 | 6,8 |
| Hak z łożyskiem WLHBW może być obracany pod obciążeniem | | | | | | | | | | |

Hak bezpieczny łańcuchowy do zawiesi łańcuchowych – klasa 8

| Kod | Kod | Łańcuch [mm] | DOR [T] | | A [mm] | B [mm] | C [mm] | H [mm] | L [mm] | S [mm] | Waga [kg/szt] |
|--------|--------|--------------|---------|-----|--------|--------|--------|--------|--------|--------|---------------|
| | | | 4:1 | 5:1 | | | | | | | |
| HTBŁ20 | HQBŁ20 | 7-8 | 2,0 | 1,6 | 86 | 33 | 10 | 123 | 165 | 38 | 0,8 |
| HTBŁ32 | HQBŁ32 | 10 | 3,2 | 2,6 | 110 | 42 | 13 | 153 | 205 | 47 | 1,5 |
| HTBŁ54 | HQBŁ54 | 13 | 5,4 | 4,3 | 137 | 52 | 16 | 190 | 255 | 67 | 2,9 |
| - | HQBŁ80 | 16 | 8,0 | 6,4 | | | | | | | |

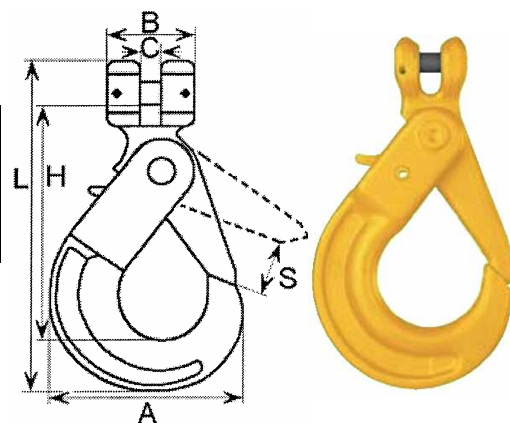

Hak bezpieczny łańcuchowy do zawiesi łańcuchowych – klasa 10

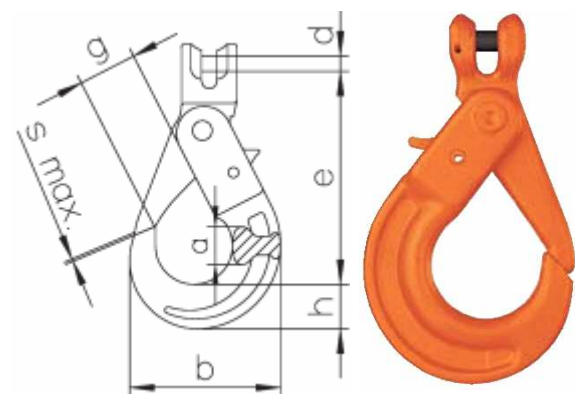

| Kod | DOR [T] | e [mm] | h [mm] | a [mm] | b [mm] | d [mm] | g [mm] | S max [mm] | Waga [kg/szt] |
|----------|---------|--------|--------|--------|--------|--------|--------|------------|---------------|
| KLHW 5/6 | 1,4 | 94 | 20 | 17 | 71 | 7,4 | 28 | 1,0 | 0,5 |
| KLHW 7 | 1,9 | 123 | 26 | 20 | 88 | 9,0 | 34 | 1,0 | 0,9 |
| KLHW 8 | 2,5 | 123 | 26 | 20 | 88 | 10,0 | 34 | 1,0 | 0,9 |
| KLHW 10 | 4,0 | 144 | 30 | 29 | 107 | 12,5 | 45 | 1,0 | 1,6 |
| KLHW 13 | 6,7 | 180 | 40 | 35 | 138 | 16,0 | 52 | 1,5 | 2,9 |
| KLHW 16 | 10,0 | 218 | 50 | 41 | 168 | 20,0 | 60 | 2,0 | 5,8 |

Komplet naprawczy do haków bezpiecznych HTBxxx

| Kod | Do haków o rozmiarach | Waga [kg/szt] |
|---------|-----------------------|---------------|
| HTBZa20 | HTB20, HTBO20, HTBŁ20 | 0,03 |
| HTBZa32 | HTB32, HTBO32, HTBŁ32 | 0,03 |
| HTBZa54 | HTB54, HTBO54, HTBŁ54 | 0,06 |
| HTBZa80 | HTB80 | 0,07 |

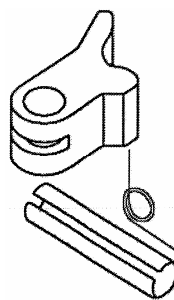

Hak skracający do zawiesi łańcuchowych – klasa 8

| Kod | Kod | Łańcuch [mm] | DOR [T] | A [mm] | B [mm] | C [mm] | D [mm] | F [mm] | H [mm] | L [mm] | S [mm] | Waga [kg/szt] |
|-------|-------|--------------|---------|--------|--------|--------|--------|--------|--------|--------|--------|---------------|
| - | HQS12 | 6 | 1,2 | | | | | | | | | |
| HTS20 | HQS20 | 7-8 | 2,0 | 52 | 35 | 15 | 10 | 31 | 66 | 96 | 10,5 | 0,27 |
| HTS32 | HQS32 | 10 | 3,2 | 75 | 46 | 20 | 13 | 40 | 83 | 130 | 13,0 | 0,73 |
| HTS54 | HQS54 | 13 | 5,4 | 95 | 58 | 25 | 16 | 52 | 106 | 165 | 16,5 | 1,23 |
| HTS80 | - | 16 | 8,0 | 110 | 68 | 30 | 21 | 57 | 120 | 185 | 20,0 | 2,30 |
| HTS92 | - | 20 | 12,5 | 148 | 77 | | 43 | 86 | 116 | 210 | 23,0 | 4,40 |

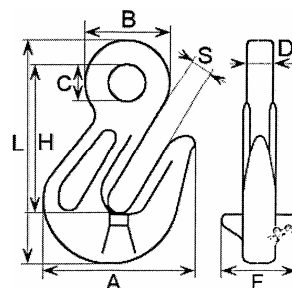

Hak skracający do zawiesi łańcuchowych – klasa 10

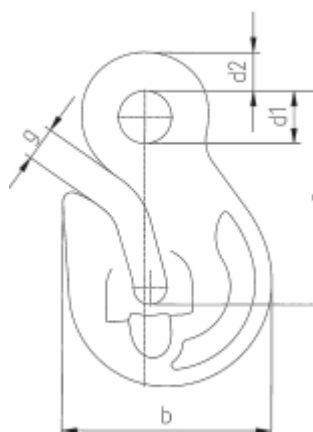

| Kod | DOR [T] | e [mm] | b [mm] | d1 [mm] | d2 [mm] | g [mm] | Waga [kg/szt] |
|----------|---------|--------|--------|---------|---------|--------|---------------|
| PW 5/6 | 1,4 | 51 | 47,4 | 12 | 8,5 | 8 | 0,18 |
| PW 7/8 | 2,5 | 70,5 | 58 | 20 | 11,5 | 10,5 | 0,4 |
| PW 10 | 4,0 | 88 | 76 | 22 | 15 | 13 | 0,9 |
| PW 13 | 6,7 | 113 | 101 | 26 | 18 | 17 | 1,8 |
| PW 16 | 10,0 | 129 | 118 | 32 | 23 | 19 | 3,6 |
| PW 19/20 | 16,0 | 151 | 150 | 36 | 27 | 24,5 | 6,15 |
| PW 22 | 19,0 | 170 | 165 | 42 | 31 | 27 | 8,3 |
| PW 26 | 26,5 | 201 | 195 | 50 | 36,6 | 31,9 | 13,8 |
| P 26 | 21,2 | 210 | 175 | 55 | 30 | 30 | 11,3 |
| P 32 | 31,5 | 240 | 210 | 60 | 40 | 39 | 18,6 |

Hak leśny do zawiesi łańcuchowych – klasa 8

| Kod | Łańcuch [mm] | DOR [T] | A [mm] | B [mm] | C [mm] | H [mm] | L [mm] | S [mm] | Waga [kg/szt] |
|--------|--------------|---------|--------|--------|--------|--------|--------|--------|---------------|
| HTŁL20 | 7-8 | 2,0 | 90 | 35 | 10 | 69 | 115 | 10 | 0,47 |

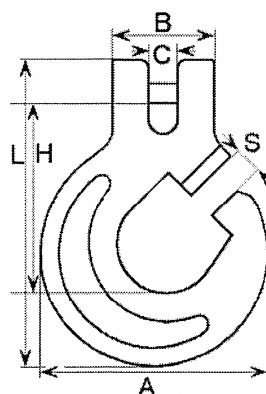

Hak kontenerowy – klasa 8

Także do zawiesi linowych

| Kod | Kod | Łańcuch [mm] | DOR [T] | A [mm] | B [mm] | C [mm] | L [mm] | S [mm] | X1 [mm] | X2 [mm] | Waga [kg/szt] |
|-------|-------|--------------|---------|--------|--------|--------|--------|--------|---------|---------|---------------|
| HTK20 | - | 7-8 | 2,0 | 125 | 48 | 24 | 121 | 161 | 62 | 19 | 0,76 |
| HTK32 | - | 10 | 3,15 | 150 | 60 | 31 | 152 | 223 | 75 | 26 | 1,78 |
| HTK54 | HQK54 | 13 | 5,4 | | | 40 | 200 | | 90 | 33 | 2,97 |
| HTK80 | - | 16 | 8,0 | | | 50 | 237 | | 102 | 41 | 6,00 |

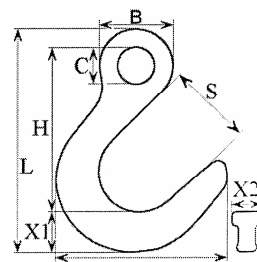

Hak kontenerowy – klasa 10

Także do zawiesi linowych

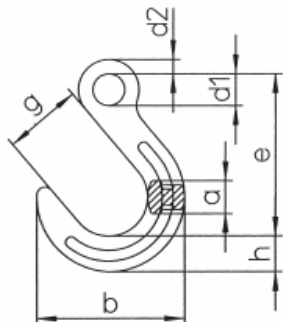

| Kod | DOR [T] | e [mm] | h [mm] | a [mm] | d1 [mm] | d2 [mm] | g [mm] | b [mm] | Waga [kg/szt] |
|----------|---------|--------|--------|--------|---------|---------|--------|--------|---------------|
| FW 7/8 | 2,5 | 131 | 29 | 25 | 24 | 11 | 64 | 118 | 0,92 |
| FW 10 | 4,0 | 158 | 35 | 32 | 31 | 14 | 76 | 143 | 1,77 |
| FW 13 | 6,7 | 190 | 42 | 42 | 39 | 17 | 89 | 170 | 2,82 |
| FW 16 | 10,0 | 224 | 50 | 50 | 47 | 22 | 102 | 200 | 5,03 |
| FW 19/20 | 16,0 | 260 | 61 | 61 | 56 | 28 | 114 | 231 | 7,6 |
| F 22 | 15,0 | 265 | 69 | 69 | 47 | 32 | 127 | 260 | 13,4 |
| F 26 | 21,2 | 305 | 80 | 80 | 54 | 34 | 136 | 280 | 19,21 |
| F 32 | 31,5 | 327 | 93 | 93 | 60 | 37 | 152 | 336 | 28 |

Hak przesuwny – klasa 8

Tylko do zawiesi linowych

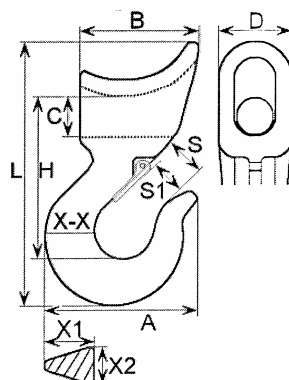

| Kod | Kod | Lina [mm] | DOR [T] | A [mm] | B [mm] | C [mm] | D [mm] | L [mm] | S [mm] | S1 [mm] | X1 [mm] | X2 [mm] | Waga [kg/szt] |
|-------|-------|-----------|---------|--------|--------|--------|--------|--------|--------|---------|---------|---------|---------------|
| HTP16 | - | 10-13 | 1,6 | 68 | 52 | 16 | 31 | 131 | 24 | 18 | 24 | 20 | 0,6 |
| HTP20 | - | 14-16 | 2,0 | 81 | 63 | 20 | 37 | 148 | 27 | 20 | 29 | 24 | 0,9 |
| HTP30 | HQP30 | 18-20 | 3,0 | 110 | 70 | 26 | 50 | 170 | 26 | 29 | 38 | 32 | 1,7 |
| HTP50 | - | 22-25 | 5,0 | 135 | 81 | 33 | 67 | 209 | 34 | 37 | 48 | 46 | 3,5 |